

Inventar de coordonate zona studiata

Nr	Y	X
1	64.1594	198.330767.888
2	64.1589	90.5330697.975
3	64.1589	67.330688.899
4	64.1589	55.3330684.4
5	64.1589	43.7330679.901
6	64.1588	89.1330658.057
7	64.1563	70.7330648.857
8	64.1561	21.7330674.402
9	64.1560	69.9330678.863
10	64.1546	119.330797.247
11	64.1556	00.2330799.869
12	64.1571	208.330802.074

**SURPALETE:**  
 S zona studiu = 5.253,00 mp  
 S teren beneficiar = 5123,00 mp  
 S teren beneficiar = 5123,00 mp  
 S desfasurata = 550,00 mp

**Indici constructivi propusi:**  
 S constructia = 550,00 mp  
 S desfasurata = 550,00 mp

**Indici urbanistici propusi:**  
 POT propus = 10,47%  
 POT max admis = 50%  
 CUT propus = 0,10 mp AOC/mp teren  
 CUT max admis = 2,5 mp AOC/mp teren

**Indici urbanistici existenti:**  
 Nu sunt constructii existente.  
 Nu sunt constructii existente.

**Indici constructivi propusi:**  
 S constructia = 550,00 mp  
 S desfasurata = 550,00 mp

**Indici urbanistici propusi:**  
 POT propus = 10,47%  
 POT max admis = 50%  
 CUT propus = 0,10 mp AOC/mp teren  
 CUT max admis = 2,5 mp AOC/mp teren

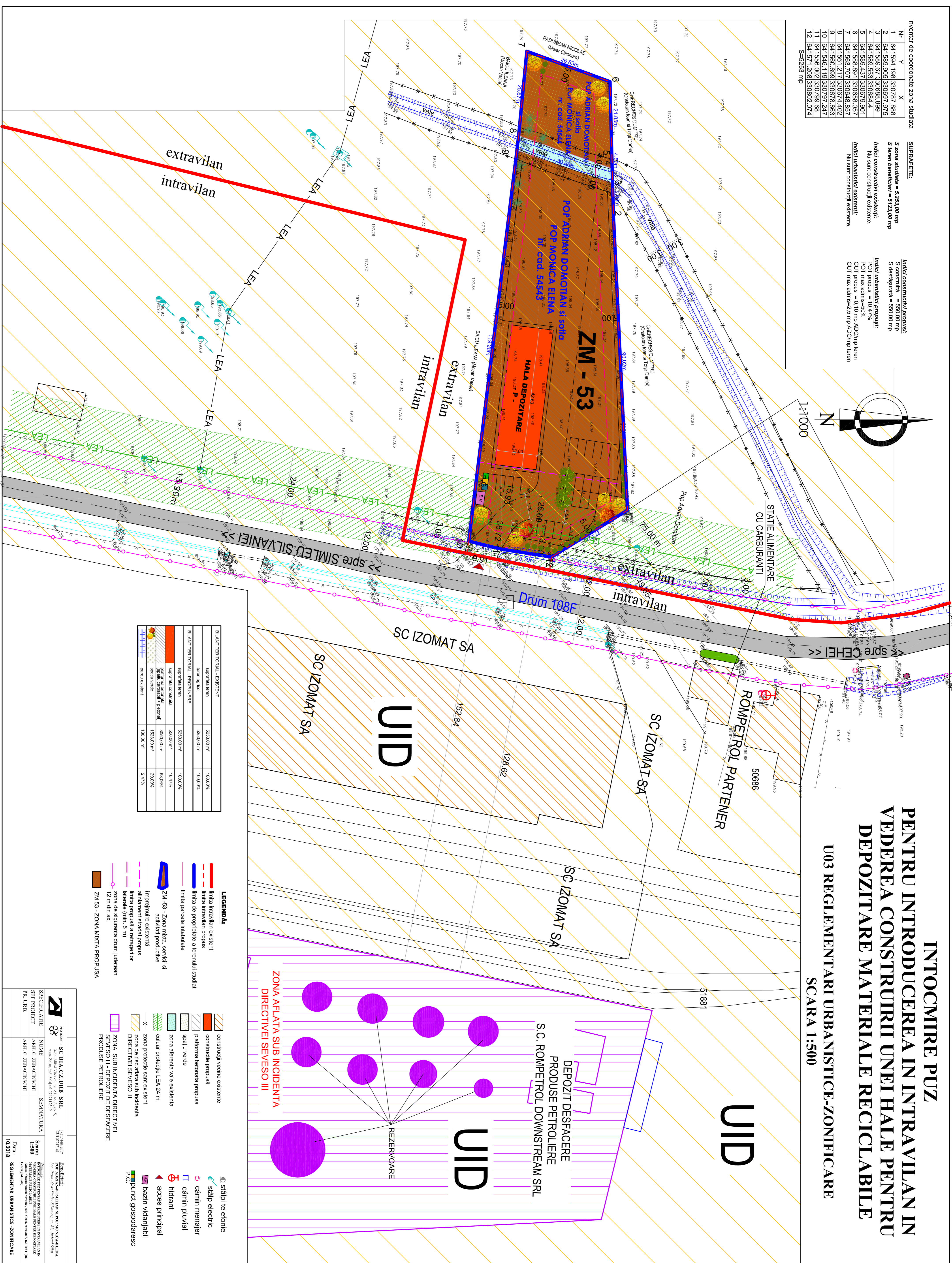
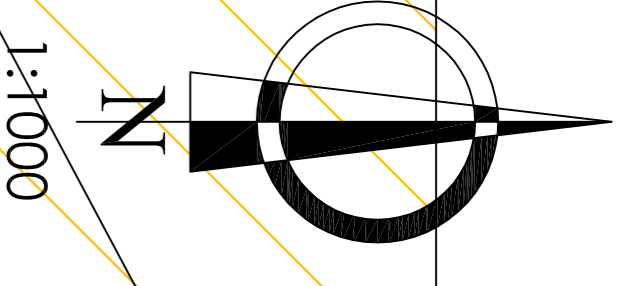

**INTOCMIRE PUZ**  
**PENTRU INTRODUCEREA IN INTRAVILAN IN**  
**VEDEREA CONSTRUIRI UNEI HALE PENTRU**  
**DEPOZITARE MATERIALE RECLICABILE**  
**U03 REGLEMETARI URBANISTICE-ZONIFICARE**  
**SCARA 1:500**

BILANT TERITORIAL - EXISTENT		
suprafata teren	5253,00 m <sup>2</sup>	100,00%
teren agricol	5253,00 m <sup>2</sup>	100,00%
BILANT TERITORIAL - PROPUNERE		
suprafata teren	5253,00 m <sup>2</sup>	100,00%
suprafata constructia	550,00 m <sup>2</sup>	10,47%
platforma betonata (gradini curtenesti + pedonali)	3095,00 m <sup>2</sup>	59,00%
suprafata verde	130,00 m <sup>2</sup>	2,47%
teren existent	130,00 m <sup>2</sup>	2,47%

- LEGENDA:**
- linia intravilan existent
  - linia intravilan propus
  - linia de proprietate a terenului studiat
  - linia parcele intabulate
  - ZM - 53 - Zona mixta servicii si activitati productive
  - imprejurime existenta
  - aliniament strada propus
  - linia propusa a retrogeniilor laterale (rim, 5 m)
  - zona de siguranta drumi iudelean 12 m din ax
  - ZM 53 - ZONA MIXTA PROPUSA
  - constructii vechi existente
  - constructii propusi
  - platforma betonata propusa
  - spatiu verde
  - zona aferenta vale existenta
  - cultura protectie LEA 24 m
  - zona de risc alina sub incidenta directivelor Seveso III
  - ZONA SUB INCIDENTA DIRECTIVEI SEVESO III DEPOZITARE DESFACERE
  - PONDUSE PETROLIENE
  - staii telefonice
  - stalp electric
  - camin menajer
  - camin pluvial
  - hidrant
  - acces principal
  - bazin vidanjabil
  - punct gospodaresc

<b>SCHEMATIC</b>	<b>SC BIA CZ URB SRL</b>	<b>11.11.2017</b>	<b>PROIECTANT</b>	<b>SC BIA CZ URB SRL</b>	<b>11.11.2017</b>
<b>SIEF PROIECT</b>	<b>ARI C ZIBACINSCHI</b>		<b>PROIECTANT</b>	<b>ARI C ZIBACINSCHI</b>	
<b>PR. URB.</b>	<b>ARI C ZIBACINSCHI</b>		<b>PROIECTANT</b>	<b>ARI C ZIBACINSCHI</b>	
<b>DATE</b>	<b>10.2018</b>		<b>PROIECTANT</b>	<b>ARI C ZIBACINSCHI</b>	